

19. SURFER MT.GYM-019



Dimensions:	1384mm x 1303mm x 839mm
Minimum space:	4,30m x 3,82m
Safety surface area:	14,5m ²
Free height of fall:	2m
Installation surface:	concrete, stone, sand, turf
Foundation depth:	300mm
Spare parts:	available at the manufacturer
Age range:	no limits (growth restrictions)
Certificate of conformity with the safety standards:	PN-EN 16630

Instructions:

Step on the platform and grab the handrail firmly. Start swinging both sides without releasing the handrail.

Material and design specifications:

Standing platform made of aluminium. Handrail made of powder coated pipe. Supporting poles made of steel tube ended at the bottom with mounting flange. Standing platform made of powder coated steel. Movable connections made with the use of rolling bearings. Installation with the use of stainless steel screws. Holes sealed at the endings with steel elements. Installed permanently in the ground.

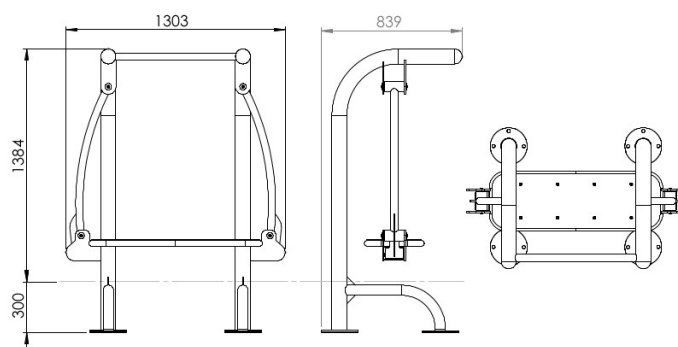
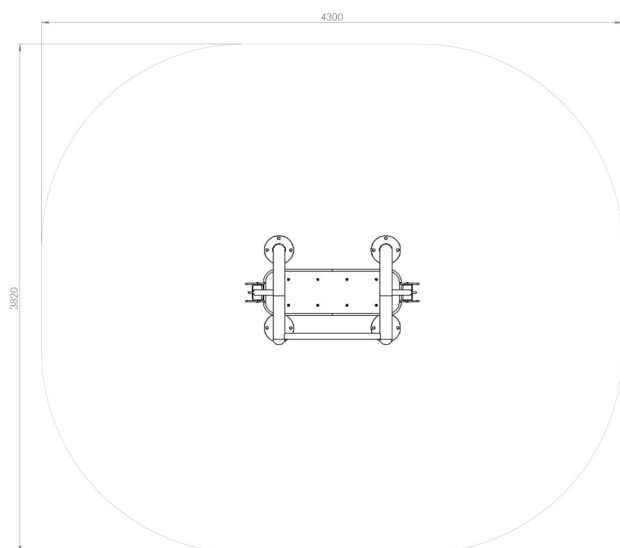

Safety surface: 14,5m²
Minimum space: 4,30m x 3,82m

Dimensions: 1384mm x 1303mm x 839mm