

07. LEG PRESS MT.GYM-007



Dimensions:	1550mm x 1150mm x 548mm
Minimum space:	4,20m x 3,55m
Safety surface area:	13m ²
Free height of fall:	1m
Installation surface:	concrete, stone, sand, turf
Foundation depth:	300mm
Spare parts:	available at the manufacturer
Age range:	no limits (growth restrictions)
Certificate of conformity with the safety standards:	PN-EN 16630

Instructions:

Sit on the seat and place your feet on the platforms. Push the legs hard until they are completely straight. Slowly get back to the starting position.

Material and design specifications:

Seat and backrest made of aluminium, covered with polyethylene ABS board. Handles made of powder coated steel tube. Supporting pole made of steel tube ended at the bottom with mounting flange. Seat and tread frame made of powder coated metal sheet. Movable connections made with the use of rolling bearings. Installation with the use of stainless steel screws. Holes sealed at the endings with steel elements.

Installed permanently in the ground.

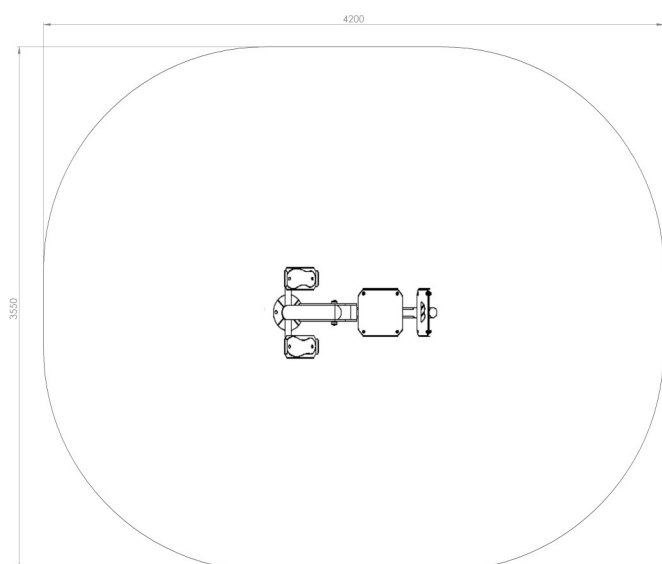

Safety surface: 13m²
Minimum space: 4,20m x 3,55m

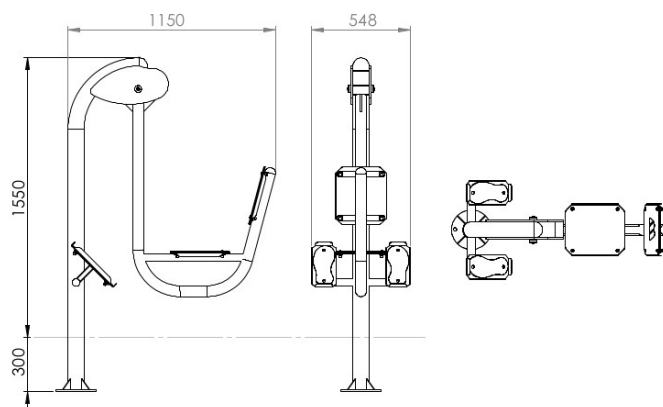

Dimensions: 1550mm x 1150mm x 548mm